

SDCCD MEASURE HH BOND PROGRAM PROJECT PROFILE — SAN DIEGO CITY COLLEGE “A” BUILDING EXPANSION HH-C-004-001

Project Teams

Design-Build Entity	Rudolph & Sletten, Inc.
Architect	Gensler
Structural Engineer	Coffman Engineers, Inc.
Civil Engineer	Latitude 33
Mech./ Elect. Engineer	P2S Engineering, Inc.
Executive Const. Manager	Ben Baker

Project Schedule

Programming Complete	Design and DSA Approval	Construction Completion (Est.)	FFE & Move-In (Est.)
January 2026	Design: November 2026 DSA: September 2027	September 2029	December 2029

Current Status/Phase:

Programming Phase

Project Insights

- The DBE team, College stakeholder groups, and District leadership have been actively engaged in multiple workshops, meetings and a Design Safari to develop the project program.
- Programming phase final documents are being refined based on feedback from deans and leadership.
- Final programming document will be presented with goal of obtaining approval by Feb 10, 2026.

Upcoming Milestones:

- 2/12/26: Interclub Council Meeting Presentation

Programming conceptual plans:

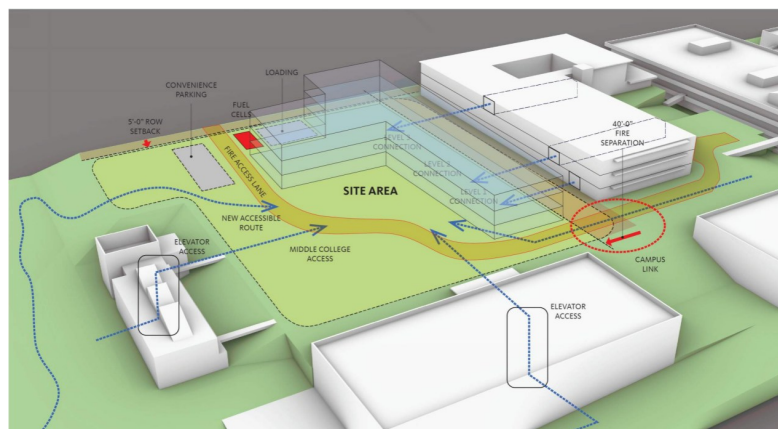
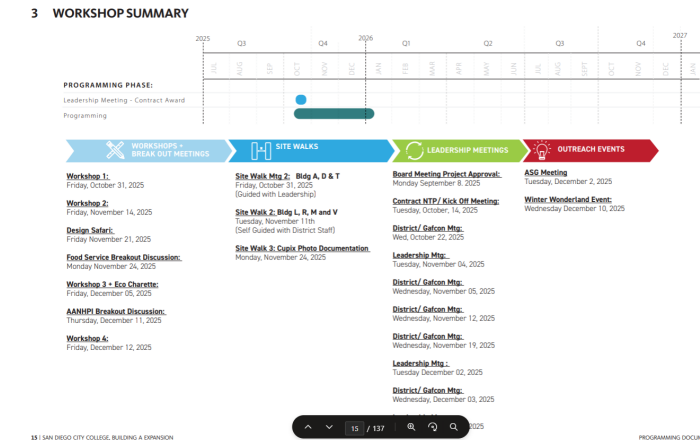
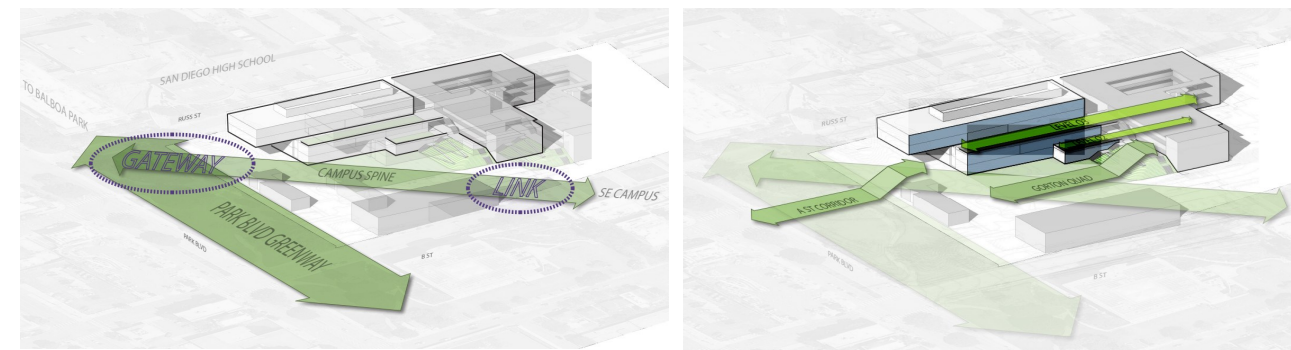

5.3 SCENARIO: MASSING CONCEPT B (4 STORY)

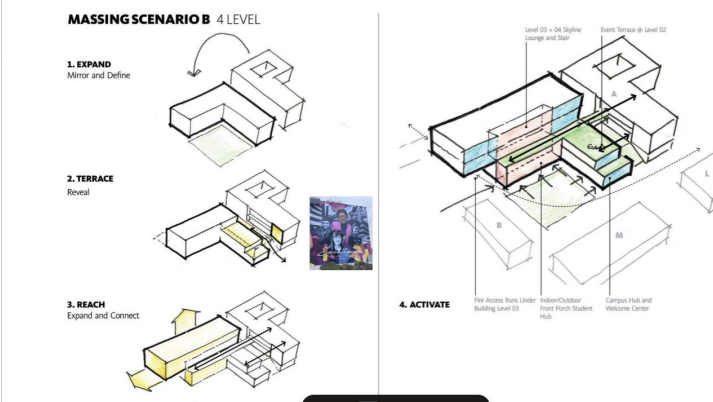

01.22.26 REVISED FOR DEAN MEETING

In response to the previous comments received at the Dean Review Meeting on 1/16/26, the design team provided a revised Option B scheme (B.1) and two additional new schemes Options C and D.

- Option C - Bookstore is on Level 1 and Dining is on Level 2
- Option D - Bookstore and Dining move to Level 2

* See also enlarged plans in back of these summaries

- Bookstore
- Dining
- Outreach and Enrollment Services
- Student Development and Matriculation
- Student Affairs
- Administrative Services
- Student Wellness
- General Student Lounge/Connective Space

CONCEPT B - SCHEME B.1

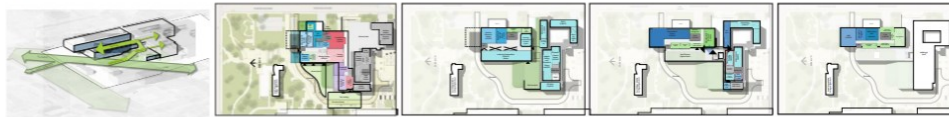

CONCEPT B - SCHEME C

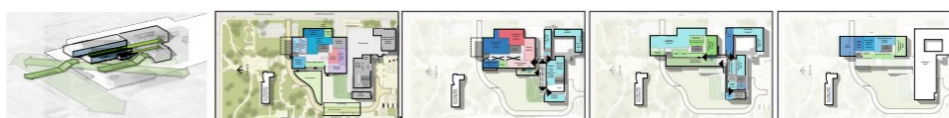

CONCEPT B - SCHEME D

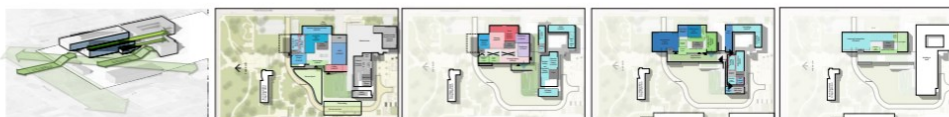

Project News & Information

Additional resources, articles, and links related to this project will appear here when available. For comprehensive information about Measure HH and all ongoing projects, please explore [the Measure HH website](#).

Project Features

The San Diego City College “A” Building Expansion project includes the abatement and demolition of the existing 32,400 SF Building D, followed by the removal and replacement of associated site utilities and appurtenances in alignment with the campus’s long-term Master Plan. New construction of approximately 71,500 assignable square feet (ASF) includes:

- Welcome Center
- Bookstore
- Commons / Food Services / Kitchen
- Outreach / Student Affairs / Student Services

Other features include:

- New utility infrastructure
- Reconstruction and/or reconfiguration of Gorton Quad
- Sustainable landscaping and irrigation
- Exterior and interior signage

Project Map



1313 Park Blvd, San Diego, CA 92101